

Installation Instructions for Linear Pendant and Joiner Box Assembly

Hardware Callout Numbers for Installation			
Part #	Part Name		
1	1/2-3/4" flat washer	10	Gem Bar
2	support beam	11	1/4 -20X3/4" countersunk screw
3	aircraft cable stud	12	canopy
4	1/2" flat nut	13	top aircraft cable stud
5	wiring harness	14	end plate
6	1/2" strain relief	15	1/4-20" nut
7	#8 pan head machine screw	16	#6 pan head machine screw
8	box covers	17	1/4-20" bolt
9	#8 Tek screw		

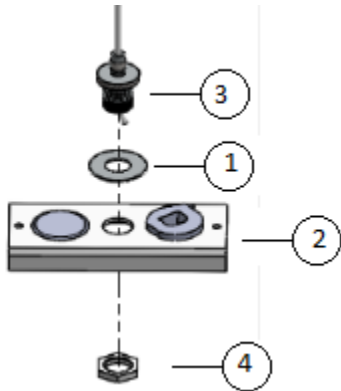

Assembling Joiner Boxes

Perform steps 1-5 while on the ground. Steps 1-5 may not apply to all assemblies.

1. Feed the **1/2-3/4" flat washer** and the **support beam** over the end of the **aircraft cable stud**.

2. Fasten the **1/2" flat nut** to the **aircraft cable stud**. This will support the joiner box.

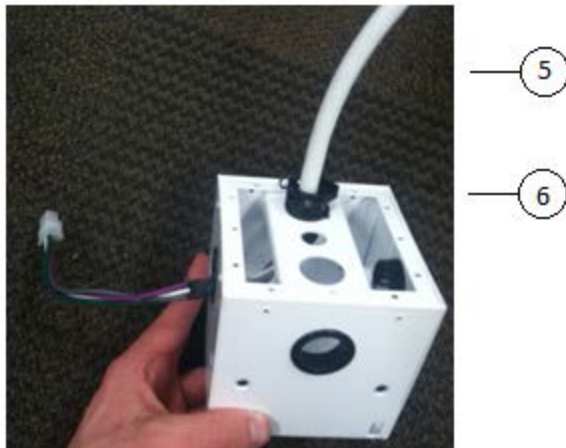

3. a. Feed the jacketed end of the **wiring harness** through **1/2" strain relief** on the **support beam**. If the fixture has an emergency pack, feed the extra power line through with the **1/2" strain relief** as well.

3. b. Pull the connector-ends of the **wiring harness** (when "pigtails" are referenced, it is the end of the harness with the clip) through the 1 1/2" access hole(s) on the joiner box and let hang. *Only one pigtail through each hole.*

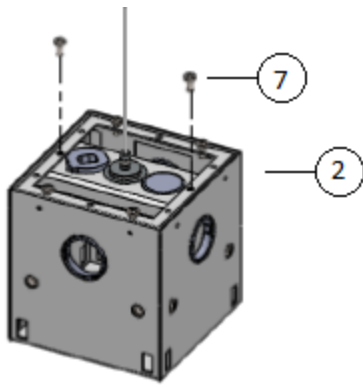

4. Hook the **support beam** under the inside lip of the joiner box and align with the middle thru holes. Secure with **#8 pan head machine screws**.

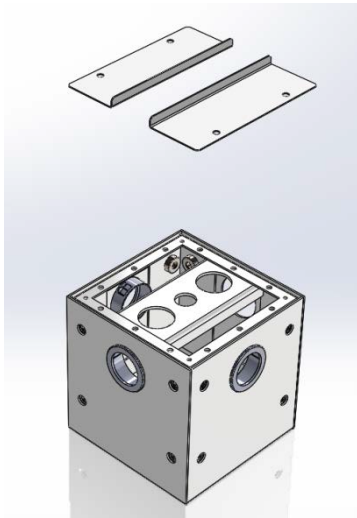

5. See photos below regarding proper cover selection and orientation for each of the 5 types of joiner box options. Secure **box covers** to the top of the joiner box using **#8 pan head machine screws**.

4-way

3-way

2-way Right "L"

2-way Linear

1-way Linear

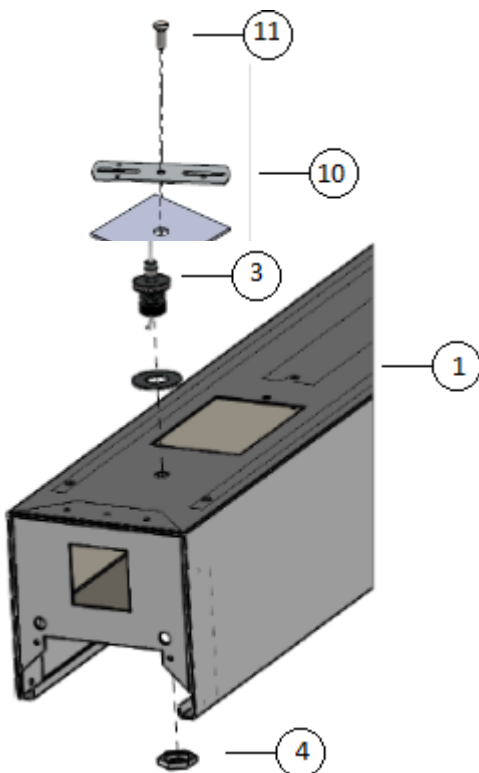

Hanging Cable Kit

1. Place the **Gem Bar** (with ground screw inserted) on top of the ceiling support. Insert **1/4 -20X3/4" countersunk screw** through center hole.

2. Align **canopy** and the **top aircraft cable stud** beneath the ceiling, and secure by tightening **1/4 -20X3/4" countersunk screw** through all.

Hanging Fixtures

The following steps require 2 people to install in order to keep the fixture level during installation. Failure to keep the fixture level

could cause bending to the fixture and/or joiner box.

Option A: With an exposed end of the fixture

1. Punch in knockout located 3" from the end with a screwdriver.
2. Feed the **1/2-3/4" flat washer** and the fixture over the end of the **aircraft cable stud**.
3. Screw the **aircraft cable stud** into the now exposed knockout. *The fit will be snug.*
3. Finish securing the fixture by fastening the **1/2" flat nut** to the **aircraft cable stud** by reaching through the access hole in the fixture. *Failure to apply the nut will leave the fixture liable to failure as the sheet metal is not designed to support weight and will likely strip out.*
4. Attach the **end plate** on to the end of the fixture by inserting the welded bolts through the companion holes on the fixture and fastening with **1/4-20" nuts**.
5. Press lens into the bottom of the fixture.

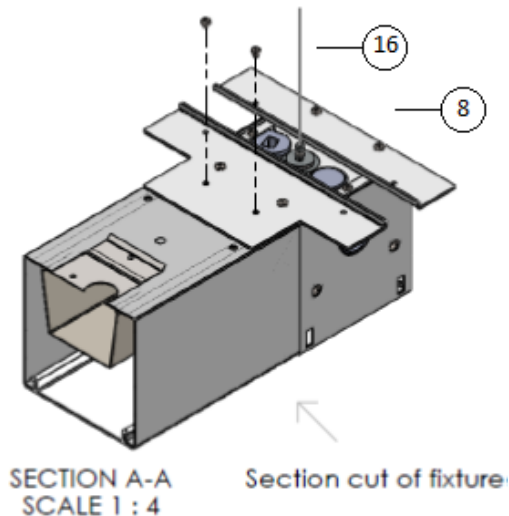
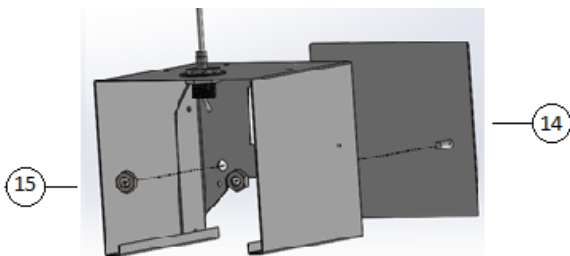

Option B: With a joiner box on the end of the fixture

1. While supporting both ends of the fixture feed one pigtail through the access hole on the end of the fixture. If the fixture has an emergency pack, feed the power line of the emergency pack through the same hole as well.
2. Remove lens, then by way of removing screws at each end of the DC-DT kit, partially remove the DC-DT kit. (as it has the harness connected to the joiner box, you are only moving the kits enough to give you the room to do step three.)

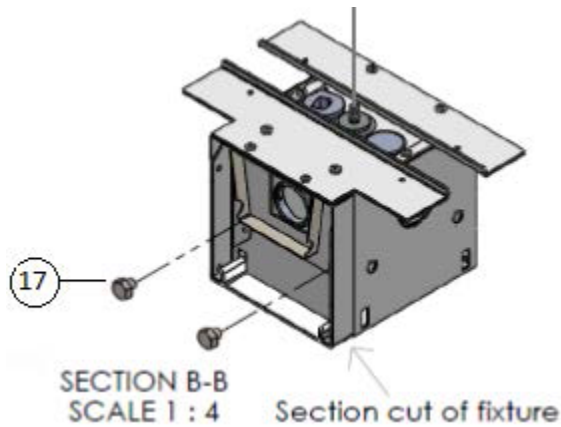

3. Finish securing the fixture to the joiner box by **10-32" bolt** into the **10-32" weld nut** from the inside of the fixture into the joiner box. Reach through the open cavity in the body to secure.

4. Replace the DC-DT kit

5. Replace lens into the bottom of the fixture.

Wiring Fixtures

1. With the fixture now secured, remove the access plate from the top of the fixture. The male end of the pigtail from the joiner box and the female end from inside the fixture should both be visible. Connect these.

2. If the fixture has an emergency pack, wire the power lines together and connect the charging cables for the battery pack. *If the battery pack is not visible, remove the access plate from the end of the fixture to expose the charging cables.*

3. On the inside of the fixtures with an emergency pack, a red button will be lit up when the fixture is powered on. Push this button to test the functionality of the battery pack.

